



**IEC Connector EN60320 C14  
with 5 x 20mm Fuseholder**

**0717 Series**

**Power Rating :** 10A 250V AC  
**Insulation Resistance :** over 100MΩ 500V DC  
**Withstanding Voltage :** 2,000V AC One Minute  
**Operating Rating Temperature :** -25°C to +85°C  
**Main Unit Material :** Thermoplastic UL Flammability  
 94V-0 & Copper Alloy



**Module**

Unit:mm

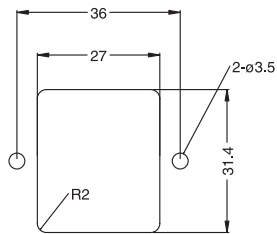
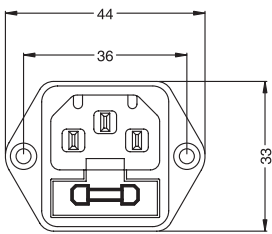

PANEL CUT-OUT

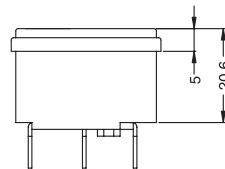
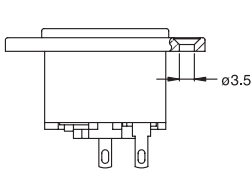

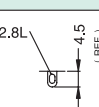
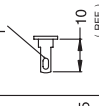
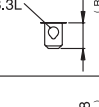
ORDER NO.	CODE	TERMINAL OPTION
0717-CS	S	2.5mm/SOLDER TAB 
0717-CLS	LS	2.8mm/SOLDER TAB 
0717-CQ	Q	4.8mm/.187" Q.D./SOLDER TAB 
0717-CW	W	6.3mm/.250" FAST-ON TAB 