



IEC Connector EN60320 C8

0721-2 Series

Power Rating : 2.5A 250V AC European & UL & CSA,
7A 125V AC UL & CUL

Insulation Resistance : over 100MΩ 500V DC

Withstanding Voltage : 2,000V AC One Minute

Operating Rating Temperature : -25°C to +85°C

Main Unit Material : Thermoplastic UL Flammability
94V-0 & Copper Alloy



Power Inlet

Unit:mm

THICKNESS: 1.0~1.2t

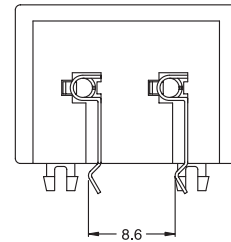
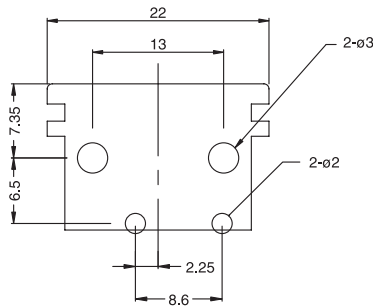
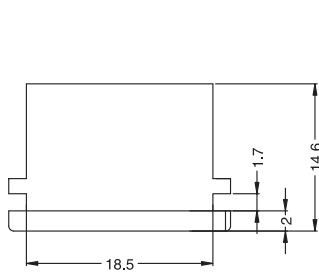

PCB. LAYOUT

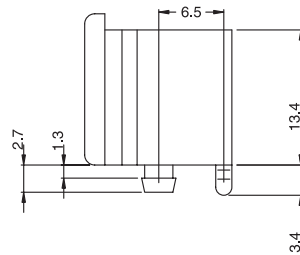
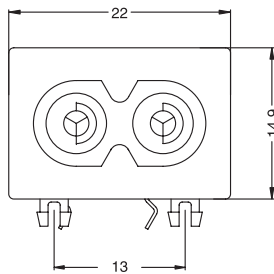

ORDER NO. 0721-2-PP

